

RAIDON

iR2771-S3 快速安裝導引 iR2772-S3

產品示意圖與配件表

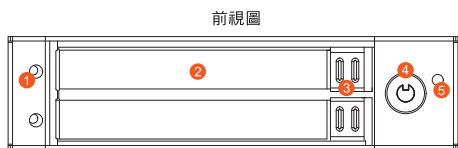

- 1 LED指示燈
- 2 硬碟抽取盒把手
- 3 頂出按鈕
- 4 硬碟抽取盒鑰匙孔
- 5 靜音按鈕

背視圖

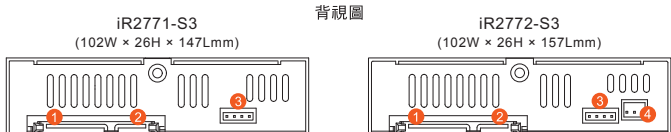

- 1 SATA 15Pin 電源輸入埠
- 2 SATA 連結埠
- 3 RAID 模式設定
- 4 RS232 埠

打開包裝外盒後，包裝內容應包含下列組件：

產品配件表

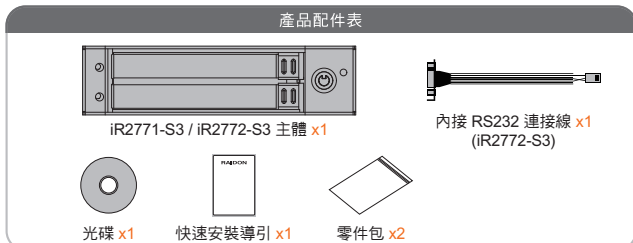

NOTE 「如需連接RS232 Cable，請確認要連接的主機板上該RS232的定義，以挑選相匹配的Cable進行使用」

請先確認相關配件與產品本身是否有受損或是缺少配件，若有任何疑問，請與您的經銷商或業務人員聯絡。

V1.0 (Jul.2016)

1

燈號說明

	藍色LED	紅色LED	蜂鳴器
硬碟閒置	恆亮	--	--
無硬碟/硬碟故障	--	恆亮	鳴叫
資料存取	恆亮	閃爍	--
資料重建(來源)	恆亮	--	--
資料重建(目標)	--	閃爍	--

硬體安裝

請參照下列步驟，完成iR2771-S3/iR2772-S3的硬體安裝：

1. 請使用背板上的RAID控制鍵選擇RAID 0或 RAID 1模式，原廠預設值為RAID 1。
2. 將主體裝置在機殼上，連接相關連接線，並確認固定螺絲是否鎖上。

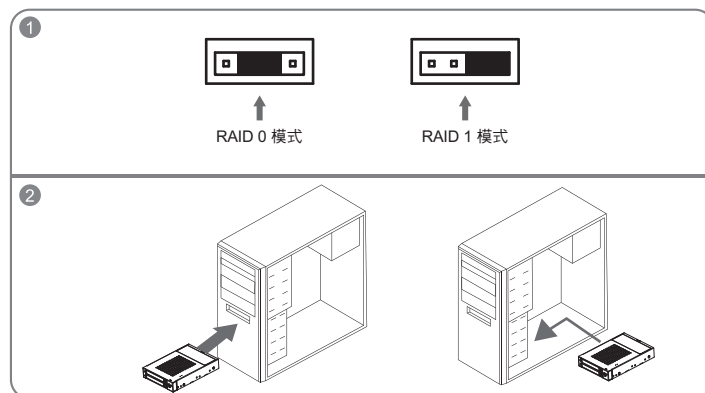

2

※ 螺絲孔位說明

3. 將您的硬碟安裝至抽取盒上。
4. 確認完成後請插回抽取盒，並確認取盒確實插入且固定在適當位置。

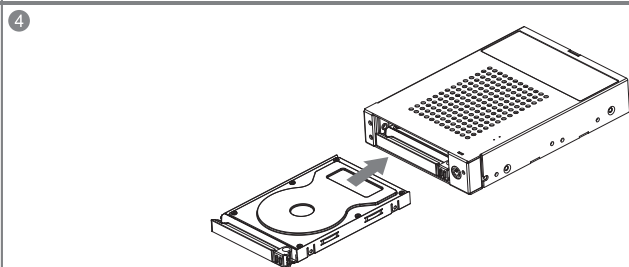
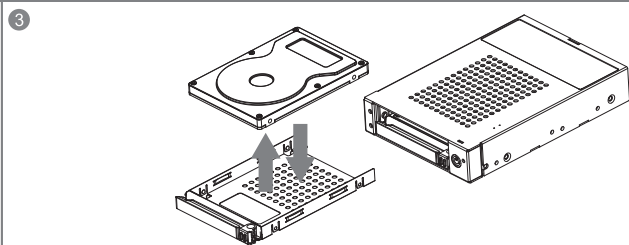
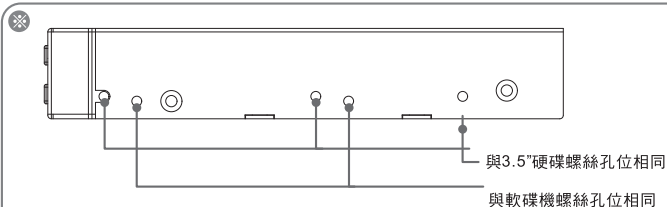

5. 硬體安裝完成。您可開啟電源進行相關設定與應用。
6. 完成。你的作業系統將會自行辨識硬體，辨識成功後請先完成硬碟格式化，完成後即可使用。

3

產品使用注意事項

1. 若想得到較佳的使用效能與選購硬碟的便利性，建議使用規格及廠牌相同的2.5吋硬碟。若RAID 1模式下，當其中有任何一顆硬碟毀損時，新更換的硬碟容量需大於或等於原硬碟容量。
2. 請確保使用的硬碟是不含壞軌的，以避免當其中一顆硬碟發生故障時，可能導致系統當機或所有資料遺失。
3. 建議於使用前決定RAID 0或RAID 1模式。使用後，若需再重新設定，請先將資料備份至其他硬碟，否則將會造成硬碟內的資料損毀。
4. 由於iR2772-S3多了RS232的功能，所以總長度較長，102W × 26H × 157Lmm (非標準2.5吋硬碟尺寸)。
5. 強烈建議除了使用iR2771-S3/iR2772-S3的資料儲存功能外，請針對重要資料備份到另一個儲存裝置上或遠端備份，雙重備份您重要的資料。若您儲存在iR2771-S3/iR2772-S3的資料損毀或遺失，RAIDON 將不負任何的責任。

感謝您使用 銳鎩科技股份有限公司 的產品。
本手冊裡的資訊在出版前雖然已經被詳細確認，但實際產品規格將以出貨時為準；任何的產品規格或相關資訊更新，請您直接上www.RAIDON.com.tw網站查詢，或是直接與您的業務聯絡窗口聯繫，本公司將不另行通知。

如果您對 銳鎩科技 的產品有任何疑問，或是想獲得最新產品訊息、使用手冊或軟體，請您聯絡 supporting@raidon.com.tw，我們將儘速回覆您。

本說明相關產品內容歸 銳鎩科技股份有限公司 版權所有

4

RAIDON

iR2771-S3 Quick Installation Guide iR2772-S3

Product Diagrams and Contents of Product Package

Front View



- ① LED Indicator
- ② Removable drive tray
- ③ HDD Tray Ejection
- ④ HDD tray key lock
- ⑤ Mute Button

Rear View

iR2771-S3
(102W × 26H × 147Lmm)

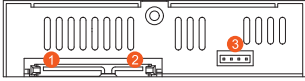

- ① 15 PIN Power Connector
- ② 4Pin Power Connector
- ③ RAID Switch

iR2772-S3
(102W × 26H × 157Lmm)

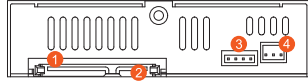

- ① 15 PIN Power Connector
- ② 4Pin Power Connector
- ③ RAID Switch
- ④ RS232 Port

After you open the outer package, make sure that the following items are contained in the package:

Contents of Product Package

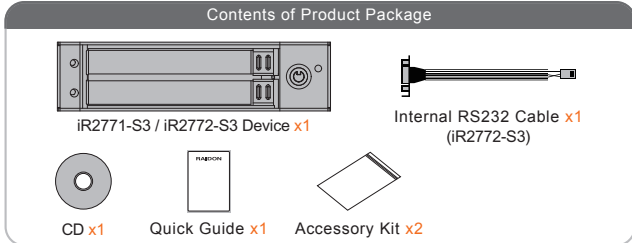

If you like to connect to RS232 port, please check the pin assignment of mother board in advance then choose the right cable.

Please make sure related accessories and product body are not missing or damaged. For any questions, please contact local distributor or retailer from your purchase for further assistance.

V1.0 (Jul.2016)

1

LED Instruction

	Blue LED	Red LED	Buzzer
HDD Idle	Light On	--	--
HDD Fail or Adsent	--	Light On	On
HDD Access	Light On	Blinking	--
Rebuilding(Source)	Light On	--	--
Rebuilding(Target)	--	Blinking	--

Hardware Installation

Please install iR2771-S3/iR2772-S3 as the following instruction.

- Choose the RAID mode with RAID switch on the back panel. The default value is RAID 1.
- Install the product unit into the computer chassis and make the necessary connections and mount the product unit properly and securely to the bay position desired.

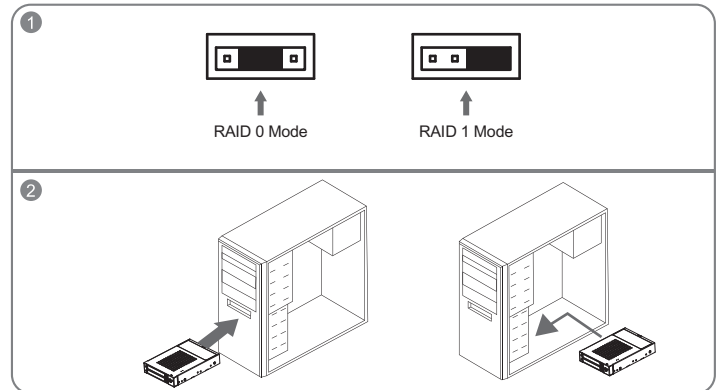

2

※ Mounting Positions

- Mount the hard drive onto the removable tray.
- Re-insert the removable tray when completed and make sure the tray is securely inserted into the appropriate position.

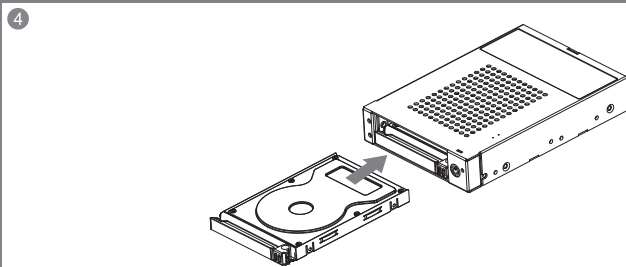
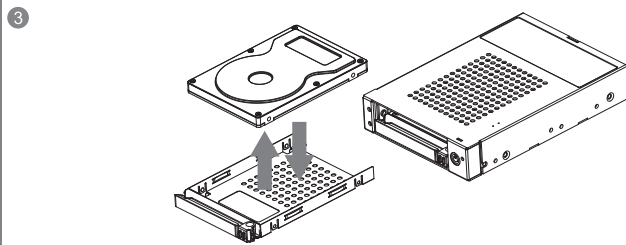
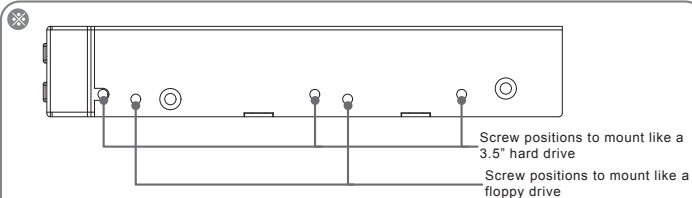

- When hardware installation is completed, you can turn on the power of the main unit to proceed with relevant settings and applications.
- Installation completed. Your operating system should automatically detect the hard drives within. Please proceed to format the drives. Once formatting is completed, you may then start to operate the device.

3

Precautions Before Application

- We suggest you using 2 brand new 2.5-inch SATA hard drives with the same brand and model number for the best performance. When any one of the hard drives is failed, please ensure that the capacity of the new hard drive is the same or bigger than the original one.
- Please ensure that the hard drives are free of bad tracks before using, otherwise, it may cause system crash in turn resulting in data loss.
- We strongly suggest you that the RAID mode should be decided before starting use iR2770. If you need to reset the RAID mode after using iR2770, please remember to backup your data on the other hard drives or the data may lose.
- Since iR 2772-S3 has the function of RS232, so the total length is longer, 102W × 26H × 157Lmm (non-standard 2.5" hard drive size).
- We strongly recommend you to keep an extra copy at your important personal data other than stored in your iR2771-S3/iR2772-S3 product. RAIDON will not be responsible of your data loss problem.

Thank you for choosing product from RAIDON Technology Inc. This information in the manual has been thoroughly checked before publication, but may not conform to the product actually delivered which mean actual product specifications depend on the product shipped to you. Any update in the specifications or product-related information shall not be subject to further notice but for the latest information on the product, please visit the website as www.RAIDON.com.tw or contact us at supporting@raidon.com.tw, and we will get back to you as soon as possible.

Copyright © RAIDON TECHNOLOGY, INC. All rights reserved.

4